

## Mini indexing plungers

Steel / Stainless Steel, opening indexing mechanism, with and without rest position

### SPECIFICATION

#### Types

- Type **B**: without rest position
- Type **C**: with rest position

#### Version in Steel ST

zinc plated, blue passivated

#### Version in Stainless Steel AISI 303 NI

Pin  
Stainless Steel AISI 303

Spring  
Stainless Steel AISI 301

Knob Plastic (Polyamide PA)

- black, matt
- red, RAL 3000 RT
- not removable

### INFORMATION

Mini indexing plungers GN 822.1 are distinguished for their small dimensions. They have been designed for installation in thin walled sheet metal constructions.

Type C with rest position is used for such applications where the plunger has to stay in its retracted position. To achieve this, the knob is rotated by 90° degrees after being retracted. A notch keeps the plunger in this position.

- Range of indexing plungers (see page 738)

### TECHNICAL INFORMATION

- Stainless Steel characteristics (see page A26)
- Plastic characteristics (see page A2)
- Load rating information (see page A42)

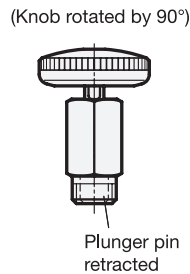
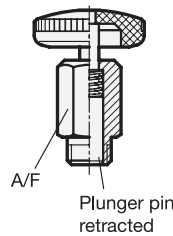
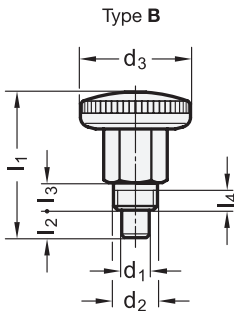

### Assembly instruction

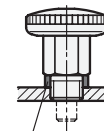

Distance bushing  
GN 609,5

## GN 822.1

Description	d1 Pin 0/-0.06 Bore +0.05/+0.1	d2	d3	l1	l2 min.	l3	l4 min.	A/F	Spring load in N $\approx$ initial	Spring load in N $\approx$ end	⚖
GN 822.1-4-B-ST	4	M 8 x 0.75	21	26.5	5	5	3.5	10	4.5	12	13
GN 822.1-5-B-ST	5	M 8 x 0.75	21	26.5	5	5	3.5	10	4.5	12	13
GN 822.1-6-B-ST	6	M 10 x 1	25	34	7	7	4.5	12	5	18	23
GN 822.1-7-B-ST	7	M 10 x 1	25	34	7	7	4.5	12	5	18	23
GN 822.1-4-C-ST	4	M 8 x 0.75	21	26.5	5	5	3.5	10	4.5	12	12
GN 822.1-5-C-ST	5	M 8 x 0.75	21	26.5	5	5	3.5	10	4.5	12	12
GN 822.1-6-C-ST	6	M 10 x 1	25	34	7	7	4.5	12	5	18	22
GN 822.1-7-C-ST	7	M 10 x 1	25	34	7	7	4.5	12	5	18	22
GN 822.1-4-B-ST-RT	4	M 8 x 0.75	21	26.5	5	5	3.5	10	4.5	12	13
GN 822.1-5-B-ST-RT	5	M 8 x 0.75	21	26.5	5	5	3.5	10	4.5	12	13
GN 822.1-6-B-ST-RT	6	M 10 x 1	25	34	7	7	4.5	12	5	18	23
GN 822.1-7-B-ST-RT	7	M 10 x 1	25	34	7	7	4.5	12	5	18	23
GN 822.1-4-C-ST-RT	4	M 8 x 0.75	21	26.5	5	5	3.5	10	4.5	12	12
GN 822.1-5-C-ST-RT	5	M 8 x 0.75	21	26.5	5	5	3.5	10	4.5	12	12
GN 822.1-6-C-ST-RT	6	M 10 x 1	25	34	7	7	4.5	12	5	18	22
GN 822.1-7-C-ST-RT	7	M 10 x 1	25	34	7	7	4.5	12	5	18	22

## GN 822.1-NI

STAINLESS STEEL

Description	d1 Pin 0/-0.06 Bore +0.05/+0.1	d2	d3	l1	l2 min.	l3	l4 min.	A/F	Spring load in N $\approx$ initial	Spring load in N $\approx$ end	⚖
GN 822.1-4-B-NI	4	M 8 x 0.75	21	26.5	5	5	3.5	10	4.5	12	13
GN 822.1-5-B-NI	5	M 8 x 0.75	21	26.5	5	5	3.5	10	4.5	12	13
GN 822.1-6-B-NI	6	M 10 x 1	25	34	7	7	4.5	12	5	18	23
GN 822.1-7-B-NI	7	M 10 x 1	25	34	7	7	4.5	12	5	18	23
GN 822.1-4-C-NI	4	M 8 x 0.75	21	26.5	5	5	3.5	10	4.5	12	12
GN 822.1-5-C-NI	5	M 8 x 0.75	21	26.5	5	5	3.5	10	4.5	12	13
GN 822.1-6-C-NI	6	M 10 x 1	25	34	7	7	4.5	12	5	18	22
GN 822.1-7-C-NI	7	M 10 x 1	25	34	7	7	4.5	12	5	18	23
GN 822.1-4-B-NI-RT	4	M 8 x 0.75	21	26.5	5	5	3.5	10	4.5	12	13
GN 822.1-5-B-NI-RT	5	M 8 x 0.75	21	26.5	5	5	3.5	10	4.5	12	13
GN 822.1-6-B-NI-RT	6	M 10 x 1	25	34	7	7	4.5	12	5	18	23
GN 822.1-7-B-NI-RT	7	M 10 x 1	25	34	7	7	4.5	12	5	18	23
GN 822.1-4-C-NI-RT	4	M 8 x 0.75	21	26.5	5	5	3.5	10	4.5	12	12
GN 822.1-5-C-NI-RT	5	M 8 x 0.75	21	26.5	5	5	3.5	10	4.5	12	13
GN 822.1-6-C-NI-RT	6	M 10 x 1	25	34	7	7	4.5	12	5	18	22
GN 822.1-7-C-NI-RT	7	M 10 x 1	25	34	7	7	4.5	12	5	18	23



Indexing elements